

FRONT VIEW

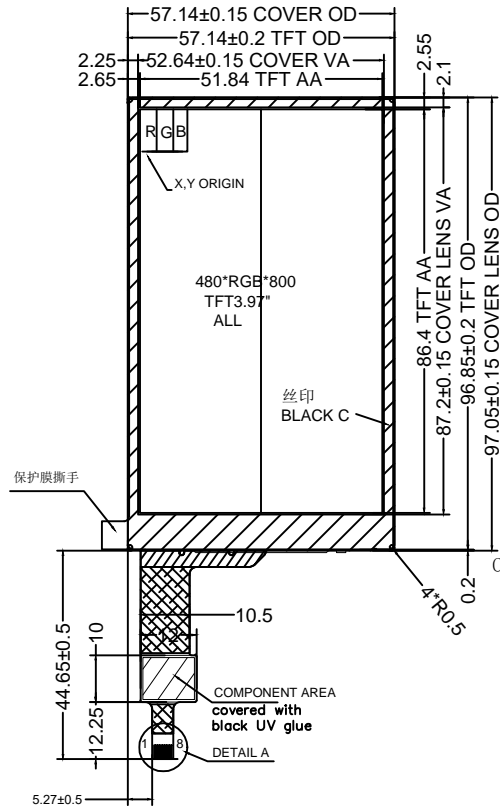

SIDE VIEW

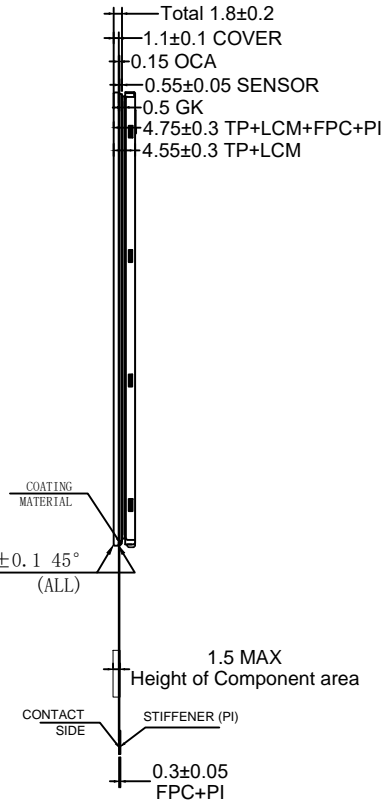

REAR VIEW

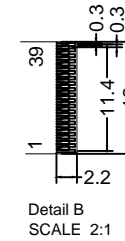
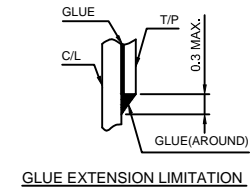
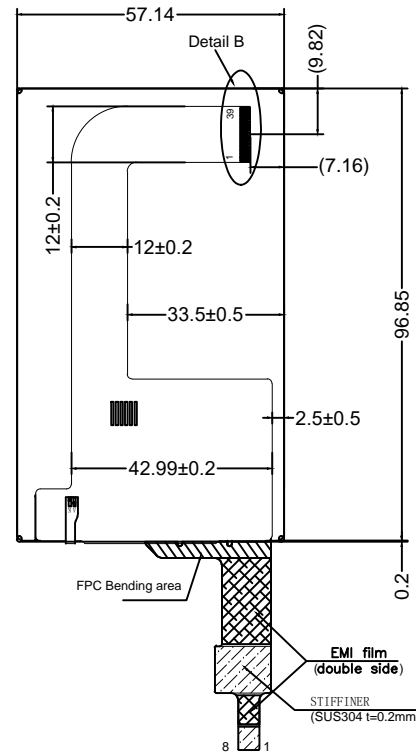

PIN NO.	SIGNAL
1	NC
2	NC
3	NC
4	NC
5	NC
6	GND
7	VCI
8	VCI
9	NC
10	GND
11	GND
12	TE
13	RESET
14	GND
15	DON
16	DOP
17	GND
18	CLKN
19	CLKP
20	GND
21	DIN
22	DIP
23	GND
24	NC
25	NC
26	IOVCC
27	GND
28	GND
29	GND
30	GND
31	NC
32	A
33	NC
34	K
35	NC
36	IDO
37	ID1
38	NC
39	NC

NOTE:

- LCD TYPE: 3.97" TFT
- LCD IC: NT35510
- VIEING DIRECTION: 85/85/85/85
- BACKLIGHT: 8 CHIPS WHITE LED
- OPERATION TEMP: -20 °C ~ 70 °C
- STORAGE TEMP: -30 °C ~ 80 °C
- GENERAL TOLERANCE: ±0.2
- Connector: FH36W-39S-0.3SHW(50)

PIN(A) PIN(K)

LED CIRCUIT DIAGRAM

Driver condition: IF=20MA; VF=24V(TYPE)
Brightness: 500cd/m2 on TP surface

CTP SPECIFICATION				PIN Def	
Structure	G+G	Transparency	≥ 86%	1	VSS1
FPC	COF	Hardness	≥ 6H	2	VDDIO(NC)
Resolution	480*800	Coordinate	Top-Left	3	VDD1(2.8/3.3V)
Driver IC	GT911	Voltage	2.8/3.3V	4	SCL(1.8V)
I/O Voltage	1.8V	Interface	IIC	5	SDA(1.8V)
IIC Address	0X5D	IIC Speed	≤ 400Kbps	6	INT(1.8V)
Frequency	60HZ			7	RST
Tst	-30 - 80	Top	-20 - 70	8	VSS1

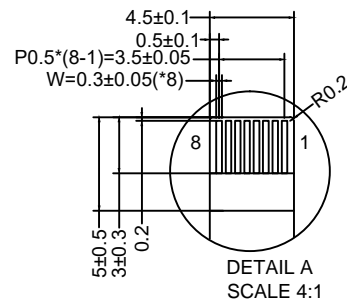

LCD WORLD LIMITED		SCALE	SHEET
		FIT	1/1
TOLERANCE (公差)		Mod. Name	
TOLERANCE UNLESS OTHERWISE SPECIFIED		LW040GFMC2-03	
UNIT	DESIGNED (structure)	DESIGNED (electron)	APPROVED
mm			DRAWING NAME
		ASSEMBLE	

01	FIRST ISSUE	2020.03.28